



# Euro-AC (M12) Series Receptacles

4 & 5 Conductor MEC Series Receptacles



Female PCB Mount Receptacles | 150V, 4A | 300V, 4A | IP67 Rating



# of Poles	Female Faceview	Rating	Style	Straight	Right Angle
4	<p>M12 x 1</p>	300V 4A	PCB Mount	MEC-4FR-PCB	MEC-4FR-PCB-R
			PCB Mount w/ Ground Tab	MECM-4FR-PCB	MECM-4FR-PCB-R
5	<p>M12 x 1</p>	150V 4A	PCB Mount	MEC-5FR-PCB	MEC-5FR-PCB-R
			PCB Mount w/ Ground Tab	MECM-5FR-PCB	MECM-5FR-PCB-R

### Female Straight

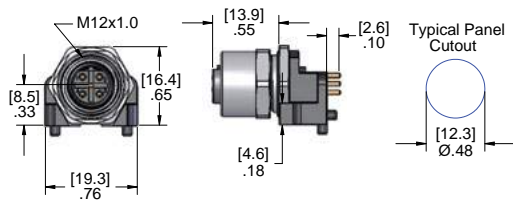

### Female Right Angle

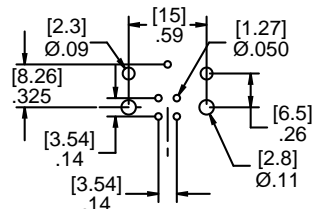
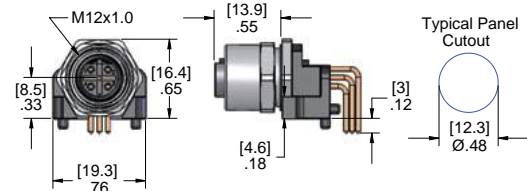

4 Pole Female Straight Layout

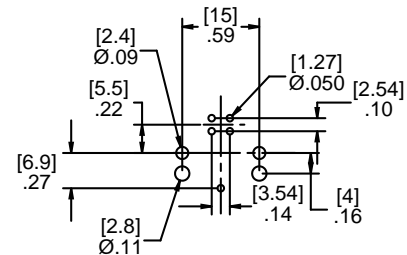

4 Pole Female Right angle Layout

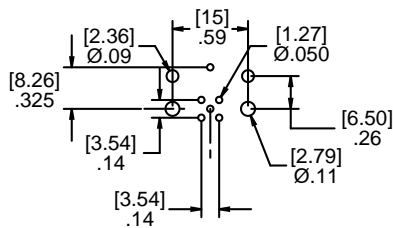

5 Pole Female Straight Layout

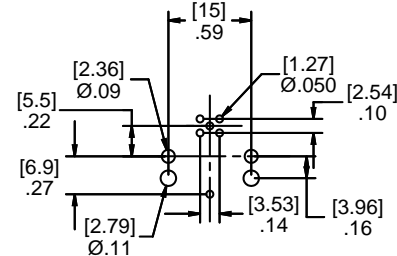

5 Pole Female Right angle Layout

### Specifications:

Body: Polyamide  
 Contacts: Copper Alloy with Gold Plating  
 Shell: Nickel Plated Brass

O-Ring: NBR  
 Jam Nut: Nickel Plated Brass  
 Temperature: -40°C to 105°C (-40°F to +221°F)

EURO-AC (M12) Series